

REFER TO PAGES 10 & 12 FOR PART DIMENSIONS

NOTE: ALL MOUNTING DIMENSIONS ARE FOR REFERENCE ONLY. PLEASE VERIFY YOUR BATTERY LAYOUT PRIOR TO FABRICATION.



CAT. NO.	"L" DIMENSION	
	For "AAAA" 0.33 (8.4) × 1.67 (42.4)	For "A27" 0.30 (7.6) × 1.10 (28.0)
50	0.89 (22.6)	0.32 (8.1)
550		



Pad Layout

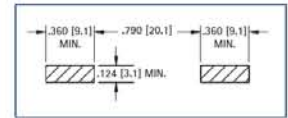

CAT. NO.	"L" DIMENSION		
	For "AAA" 0.41 (10.4) × 1.75 (44.5)	For "N" 0.45 (11.4) × 1.14 (29.0)	For "A23" 0.40 (10.2) × 1.10 (27.9)
55	1.76 (44.7)	1.15 (29.2)	1.11 (28.2)
555			

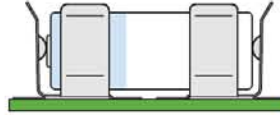

Pad Layout

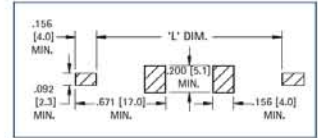

CAT. NO.	"L" DIMENSION		
	For "AA" 0.56 (14.2) × 1.98 (50.3)	For "2/3 A" 0.67 (17.0) × 1.36 (34.5)	For "CR2" 0.60 (15.2) × 1.05 (26.7)
53	2.05 (52.1)	1.38 (35.1)	1.04 (26.4)
553			

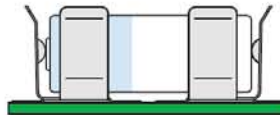

Pad Layout

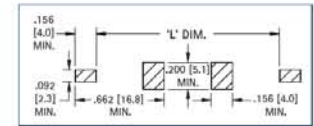

CAT. NO.	"L" DIMENSION		
	For "AAA" 0.41 (10.4) × 1.75 (44.5)	For "N" 0.45 (11.4) × 1.14 (29.0)	For "A23" 0.4 (10.2) × 1.10 (27.9)
56	1.67 (42.4)	1.07 (27.2)	1.02 (25.9)
556			

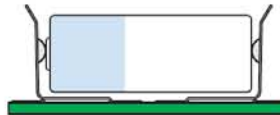

Pad Layout

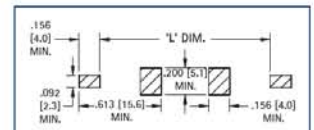

CAT. NO.	"L" DIMENSION		
	For "AA" 0.56 (14.2) × 1.98 (50.3)	For "2/3 A" 0.67 (17.0) × 1.36 (34.5)	For "CR2" 0.60 (15.2) × 1.05 (26.7)
5231	2.38 (60.5)	1.71 (43.4)	1.53 (24.6)
5331			

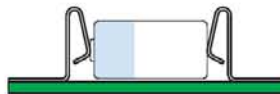

Pad Layout

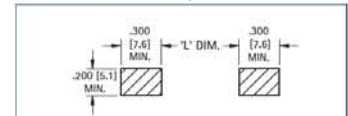

"L" dimensions reflect initial insertion deflection.



CAT. NO.	"L" DIMENSION		
	For "AA" 0.56 (14.2) × 1.98 (50.3)	For "C" 1.00 (25.4) × 1.97 (50.0)	For "D" 1.30 (33.0) × 2.42 (61.5)
99	0.91 (23.0)	—	—
100	—	—	—
86	—	0.91 (23.0)	—
87	—	—	1.19 (30.2)
88	—	—	—
89	—	—	—

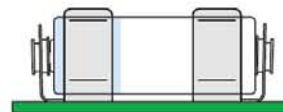

Mounting Detail

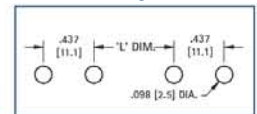

CAT. NO.	"L" DIMENSION		
	For "AA" 0.56 (14.2) × 1.98 (50.3)	For "C" 1.00 (25.4) × 1.97 (50.0)	For "D" 1.30 (33.0) × 2.42 (61.5)
206	1.10 (27.9)	—	—
207	—	0.81 (20.6)	—
208	—	—	1.25 (31.8)



Mounting Detail

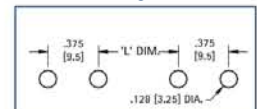

REFER TO PAGE 11 FOR PART DIMENSIONS

NOTE: ALL MOUNTING DIMENSIONS ARE FOR REFERENCE ONLY. VERIFY YOUR BATTERY LAYOUT PRIOR TO FABRICATION.

Mounting Detail

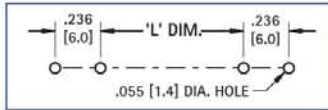

CAT. NO.	"L" DIMENSION	
	For "AAA"	For "A27"
51	0.33 (8.4) × 1.67 (42.4)	0.300 (7.6) × 1.10 (27.9)
	1.07 (27.2)	0.50 (12.7)



51

Mounting Detail

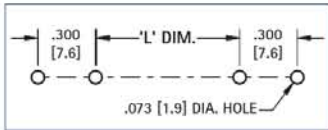

CAT. NO.	"L" DIMENSION		
	For "AAA"	For "N"	For "A23"
82	0.41 (10.4) × 1.75 (44.5)	0.45 (11.4) × 1.14 (29.0)	0.40 (10.2) × 1.10 (27.9)
	1.08 (27.4)	0.47 (11.9)	0.43 (10.9)

CAT. NO.	"L" DIMENSION		
	For "AA"	For "2/3 A"	For "CR2"
52	0.56 (14.2) × 1.98 (50.3)	0.67 (17.0) × 1.36 (34.5)	0.60 (15.2) × 1.05 (26.7)
92	1.32 (33.5)	0.67 (17.0)	0.39 (9.9)
2915	1.32 (33.5)	-	0.39 (9.9)

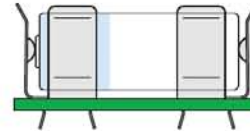

82

92

2915

52

Mounting Detail

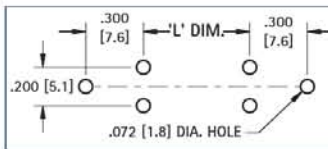

CAT. NO.	"L" DIMENSION			
	For "18650"	For "18350"	For "2/3 A"	For "17500"
54	0.71 (18.4) × 2.56 (65.0)	0.73 (18.5) × 1.38 (35.0)	0.67 (17.0) × 1.36 (34.5)	0.67 (17.0) × 1.97 (50.0)
	1.85 (47.0)	0.57 (14.5)	0.57 (14.5)	1.22 (30.9)

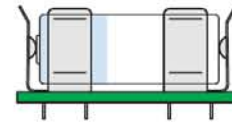

54

Mounting Detail

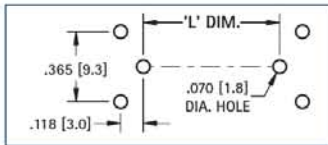

CAT. NO.	"L" DIMENSION		
	For "2/3 A"	For "CR2"	For "AA"
595 with 628	0.67 (17.0) × 1.36 (34.5)	0.60 (15.2) × 1.05(26.7)	0.56 (14.2) × 1.98 (50.3)
	1.46 (37.1)	1.18 (30.0)	2.08 (52.8)

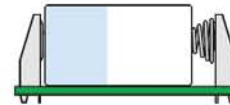

628

595

Mounting Detail

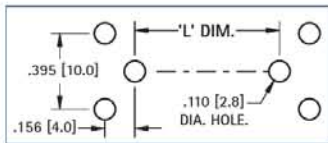

CAT. NO.	"L" DIMENSION		
	For "AAA"	For "N"	For "A23"
637 with 629	0.41 (10.4) × 1.75 (44.5)	0.45 (11.4) × 1.14 (29.0)	0.40 (10.2) × 1.10 (27.9)
	1.88 (47.8)	1.27 (32.3)	1.23 (31.2)



637



629

Mounting Detail

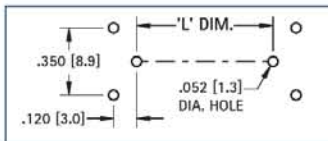

CAT. NO.	"L" DIMENSION		
	For "AA"	For "2/3 A"	For "CR2"
596 with 597	0.56 (14.2) × 1.98 (50.3)	0.67 (17.0) × 1.36 (34.5)	0.60 (15.2) × 1.05 (26.7)
597 with 597	2.07 (52.6)	N/A	1.14 (29.0)
590 with 590	2.15 (54.6)	1.50 (38.1)	1.22 (31.0)

CAT. NO.	"L" DIMENSION		
	For "AAA"	For "N"	For "A23"
597 with 591	0.41 (10.4) × 1.75 (44.5)	0.45 (11.4) × 1.14 (29.0)	0.40 (10.2) × 1.10 (27.9)
591 with 591	1.83 (46.5)	1.22 (31.0)	1.18 (30.0)
	1.91 (48.5)	1.30 (33.0)	1.26 (32.0)

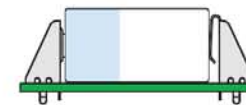

596

597



590

591

"L" dimensions reflect initial insertion deflection.

REFER TO PAGES 14 & 15 FOR PART DIMENSIONS

NOTE: ALL MOUNTING DIMENSIONS ARE FOR REFERENCE ONLY. PLEASE VERIFY YOUR BATTERY LAYOUT PRIOR TO FABRICATION.

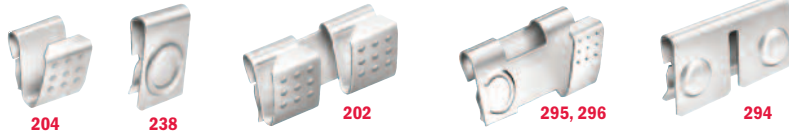

CAT. NO.	FIG. NO.	L DIMENSION				
		For "AAAA" 0.33 (8.4) × 1.67 (42.4)	For "A 27" 0.30 (7.6) × 1.10 (27.9)	For "A23" 0.40 (10.2) × 1.10 (27.9)	For "AAA" 0.41 (10.4) × 1.75 (44.5)	For "N" 0.45 (11.4) × 1.14 (29.0)
204 with 238	1	1.79 (45.5)	1.22 (31.0)	1.22 (31.0)	1.87 (47.5)	1.26 (32.0)
204,238 with 295, 296	1	N/A	N/A	N/A	1.87 (47.5)	N/A
202 with 294	1	N/A	N/A	N/A	1.87 (47.5)	N/A
204 with 204	2	1.89 (48.0)	1.32 (33.5)	1.32 (33.5)	1.97 (50.0)	1.36 (34.5)
204 with 202	2	N/A	N/A	N/A	1.97 (50.0)	N/A

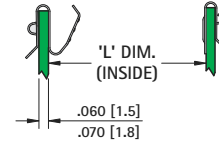

Fig. 1 Spring-Button
L dimensions reflect initial insertion deflection.



CAT. NO.	FIG. NO.	L DIMENSION		
		For "AA" 0.56 (14.2) × 1.98 (50.3)	For "CR2" 0.60 (15.2) × 1.05 (26.7)	For "2/3 A" 0.67 (17.0) × 1.24 (31.5)
209 with 228	1	2.13 (54.1)	12.0 (30.5)	1.46 (37.1)
209, 228 with 290, 291	1	2.13 (54.1)	N/A	N/A
288, 210 with 292	1	2.13 (54.1)	N/A	N/A
209 with 209	2	2.27 (57.7)	1.34 (34.0)	1.60 (40.6)
209 with 288, 210	2	2.27 (57.7)	N/A	N/A

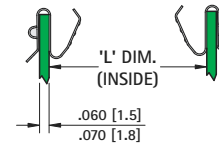
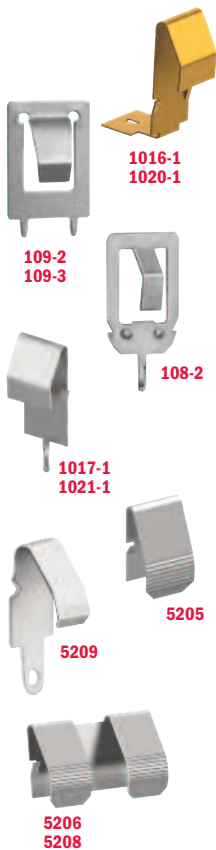

Fig. 2 Spring-Spring
L dimensions reflect initial insertion deflection.

*Built in circuit protection may increase length of battery, check battery specifications for exact battery length



CAT. NO.	FIG. NO.	L DIMENSION					
		For "AA" 0.56 (14.2) × 1.98 (50.3)	For "CR2" 0.60 (15.2) × 1.05 (26.7)	For "2/3 A" 0.67 (17.0) × 1.24 (31.5)	For "17500" 0.67 (17.0) × 1.97 (50.0)	For "18350" 0.71 (18.0) × 1.38 (35.0)	For "18650" 0.71 (18.0) × 2.56 (65.0)
5205	3	2.28 (57.9)	1.35 (34.3)	1.61 (40.9)	2.27 (57.7)	1.68 (42.7)	2.86 (72.6)
5205 with 5206	3	2.28 (57.9)	N/A	N/A	N/A	N/A	N/A
5209	3	2.34 (59.4)	1.41 (35.8)	1.67 (42.4)	2.33 (59.2)	1.74 (44.2)	2.92 (74.2)
5209 with 5208	3	2.34 (59.4)	N/A	N/A	N/A	N/A	N/A
1016-1	4	2.19 (55.6)	1.26 (32.0)	1.52 (38.6)	2.18 (55.4)	1.59 (40.4)	2.77 (70.4)
1017-1	3	2.19 (55.6)	1.26 (32.0)	1.52 (38.6)	2.18 (55.4)	1.59 (40.4)	2.77 (70.4)

*Built in circuit protection may increase length of battery, check battery specifications for exact battery length

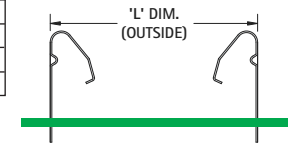

Fig. 3 PC Mount
L dimensions reflect initial insertion deflection.

CAT. NO.	FIG. NO.	L DIMENSION				
		For "AAAA" 0.33 (8.4) × 1.67 (42.4)	For "A27" 0.30 (7.6) × 1.10 (27.9)	For "A23" 0.40 (10.2) × 1.10 (27.9)	For "AAA" 0.41 (10.4) × 1.75 (44.5)	For "N" 0.45 (11.4) × 1.14 (29.0)
1021-1	3	1.88 (47.8)	1.31 (33.3)	1.31 (33.3)	1.96 (49.8)	1.35 (34.3)
1020-1	4	1.88 (47.8)	1.31 (33.3)	1.31 (33.3)	1.96 (49.8)	1.35 (34.3)

CAT. NO.	FIG. NO.	L DIMENSION			
		For "AAA" 0.41 (10.4) × 1.75 (44.5)	For "N" 0.45 (11.4) × 1.14 (29.0)	For "AA" 0.56 (14.2) × 1.98 (50.3)	For "CR2" 0.60 (15.2) × 1.05 (26.7)
108-2	3	1.99 (50.5)	1.38 (35.0)	2.22 (56.4)	1.29 (32.8)
					For "2/3A" 0.67 (17.0) × 1.24 (31.5)
					1.55 (39.4)

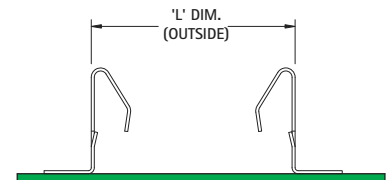

Fig. 4 Surface Mount
L dimensions reflect initial insertion deflection.

CAT. NO.	FIG. NO.	L DIMENSION									
		For "AA" 0.56 (14.2) × 1.98 (50.3)	For "CR2" 0.60 (15.2) × 1.05 (26.7)	For "2/3 A" 0.67 (17.0) × 1.24 (31.5)	For "17500" 0.67 (17.0) × 1.97 (50.0)	For "18350" 0.71 (18.0) × 1.38 (35.0)	For "18650" 0.71 (18.0) × 2.56 (65.0)	For "C" 0.99 (25.0) × 1.97 (50.0)	For "26650" 1.02 (26.0) × 2.56 (65.0)	For "D" 1.30 (33.0) × 2.24 (56.9)	
1107-1	3	2.19 (55.6)	1.26 (32.0)	1.52 (38.6)	2.18 (55.4)	1.59 (40.4)	2.77 (70.4)	2.18 (55.4)	2.77 (70.4)	2.45 (62.2)	
109-2	3	2.22 (56.4)	1.29 (32.8)	1.55 (39.4)	2.21 (56.1)	1.62 (41.1)	2.80 (71.1)	N/A	N/A	N/A	
109-3	3	N/A	N/A	N/A	N/A	N/A	N/A	2.21 (56.1)	1.62 (41.1)	2.48 (63.0)	

*Built in circuit protection may increase length of battery, check battery specifications for exact battery length



CAT. NO.	FIG. NO.	L DIMENSION				
		For "AAAA" 0.33 (8.4) × 1.67 (42.4)	For "A27" 0.30 (7.6) × 1.10 (27.9)	For "A23" 0.40 (10.2) × 1.10 (27.9)	For "AAA" 0.41 (10.4) × 1.75 (44.5)	For "N" 0.45 (11.4) × 1.14 (29.0)
230-1	5	1.65 (42.4)	1.08 (27.9)	1.08 (27.9)	1.73 (43.9)	1.12 (29.0)

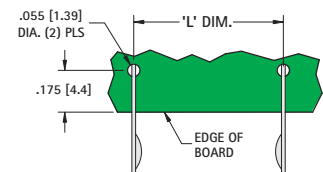

Fig. 5 Off-Board Mount

REFER TO PAGE 16 THRU 18 FOR PART DIMENSIONS

NOTE: ALL MOUNTING DIMENSIONS ARE FOR REFERENCE ONLY. VERIFY YOUR BATTERY LAYOUT PRIOR TO FABRICATION.

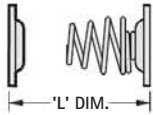

Fig. 1



5203



5225



5204



5226



5213, 5214

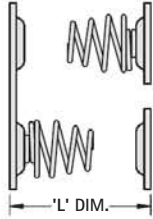

Fig. 2

CAT. NO.	"L" DIMENSION					
	FIG. NO.	For "AAA" 0.33 (8.4) × 1.67 (42.4)	For "A27" 0.30 (7.6) × 1.10 (27.9)	For "A23" 0.40 (10.2) × 1.10 (27.9)	For "AAA" 0.41 (10.4) × 1.75 (44.5)	For "N" 0.45 (11.4) × 1.14 (29.0)
5203 with 5225	1	1.87 (47.5)	1.30 (33.0)	1.30 (33.0)	1.95 (49.5)	1.34 (34.0)
5204 with 5226	1	1.87 (47.5)	1.30 (33.0)	1.30 (33.0)	1.95 (49.5)	1.34 (34.0)
5214,5213 with 5203, 5225	2	N/A	N/A	N/A	1.95 (49.5)	N/A

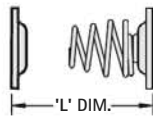

Fig. 1



5201, 5220



5202, 5222



5210, 5211
5218, 5219



5212

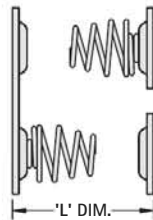

Fig. 2



5219, 5223



5221, 5224



5227



5228

CAT. NO.	"L" DIMENSION						
	FIG. NO.	For "AA" 0.56 (14.2) × 1.98 (50.3)	For "CR2" 0.60 (15.2) × 1.05 (26.7)	For "2/3 A" 0.67 (17.0) × 1.36 (34.5)	For "17500" 0.67 (17.0) × 1.97 (50.0)	For "18350" 0.71 (18.0) × 1.38 (35.0)	For "18650" 0.71 (18.0) × 2.56 (65.0)
5202 with 5224	1	2.23 (56.6)	1.30 (33.0)	1.61 (40.9)	2.22 (56.5)	1.63 (41.4)	2.81 (71.4)
5222 with 5221	1	2.24 (56.9)	1.31 (33.3)	1.62 (41.1)	2.23 (56.6)	1.64 (41.7)	2.82 (71.6)
5201 with 5223	1	2.24 (56.9)	1.31 (33.3)	1.62 (41.1)	2.23 (56.6)	1.64 (41.7)	2.82 (71.6)
5220 with 5219	1	2.24 (56.9)	1.31 (33.3)	1.62 (41.1)	2.23 (56.6)	1.64 (41.7)	2.82 (71.6)
5201, 5223 with 5210, 5211	2	2.24 (56.9)	N/A	N/A	N/A	N/A	N/A
5222, 5221 with 5212	2	2.24 (56.9)	N/A	N/A	N/A	N/A	N/A
5220, 5219 with 5217, 5218	2	2.24 (56.9)	N/A	N/A	N/A	N/A	N/A
5227 with 5228	2	2.24 (56.9)	N/A	N/A	N/A	N/A	N/A

*Built in circuit protection may increase length of battery, check battery specifications for exact battery length

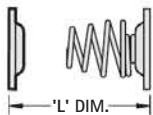

Fig. 1



5240



5241



5242



5250



5251



5252, 5253

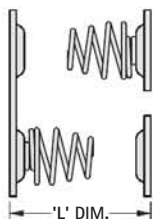

Fig. 2

CAT. NO.	"L" DIMENSION			
	FIG. NO.	For "C" 0.99 (25.0) × 1.97 (50.0)	For "26650" 1.02 (26.0) × 2.56 (65.0)	For "D" 1.30 (33.0) × 2.24 (56.9)
5220 with 5241	1	2.25 (57.2)	3.07 (78.0)	N/A
5250 with 5251	1	N/A	N/A	2.75 (69.9)
5240, 5241 with 5242	2	2.25 (57.2)	N/A	N/A
5250, 5251 with 5252, 5253	2	N/A	N/A	2.75 (69.9)

*Built in circuit protection may increase length of battery, check battery specifications for exact battery length